

**BEN PEARSON**

**PARTS MANUAL – MODEL 9000FC**

**2912 W. 2ND.  
PINE BLUFF, ARKANSAS 71601  
1-800-436-1327**

9PC

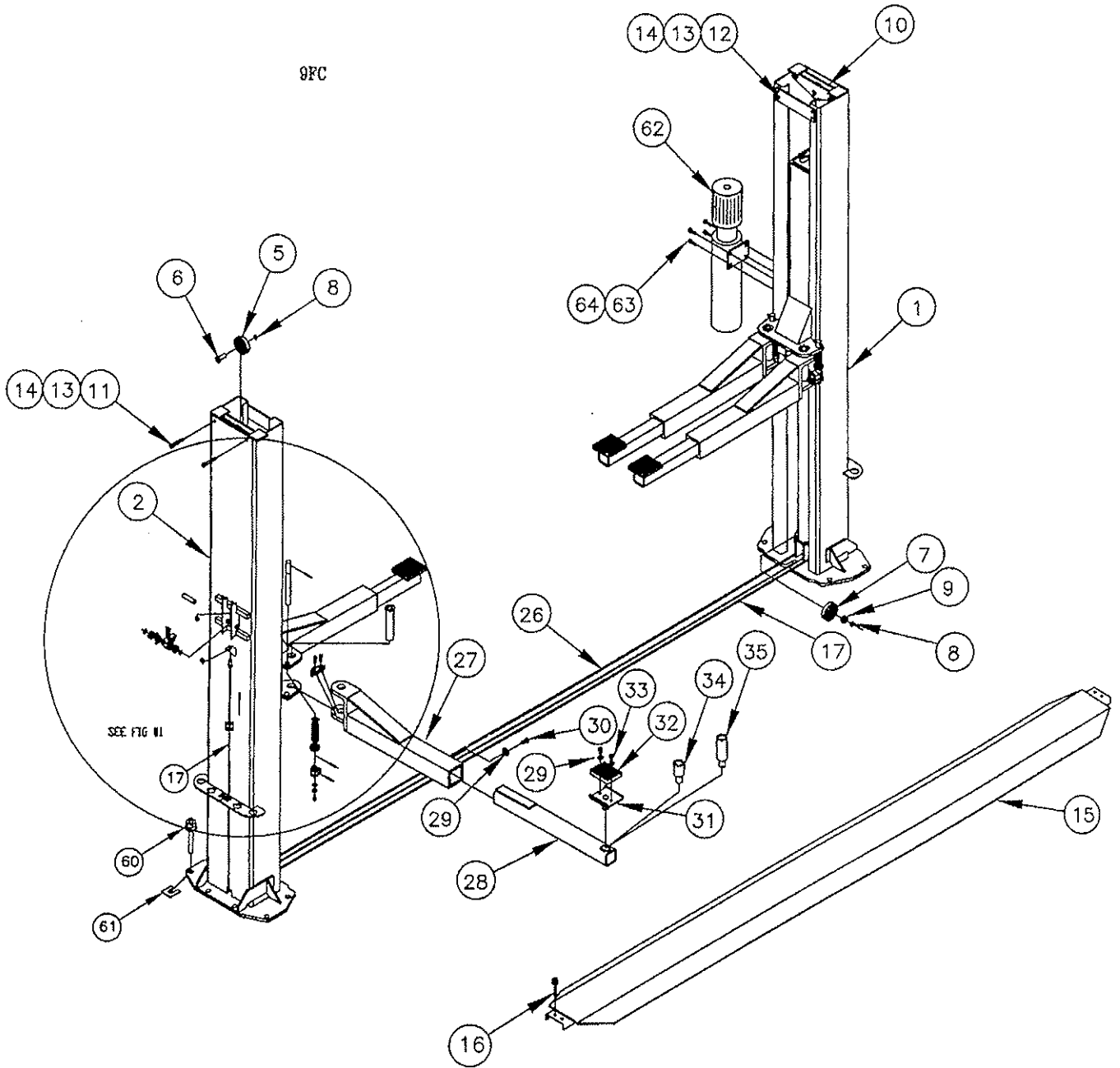

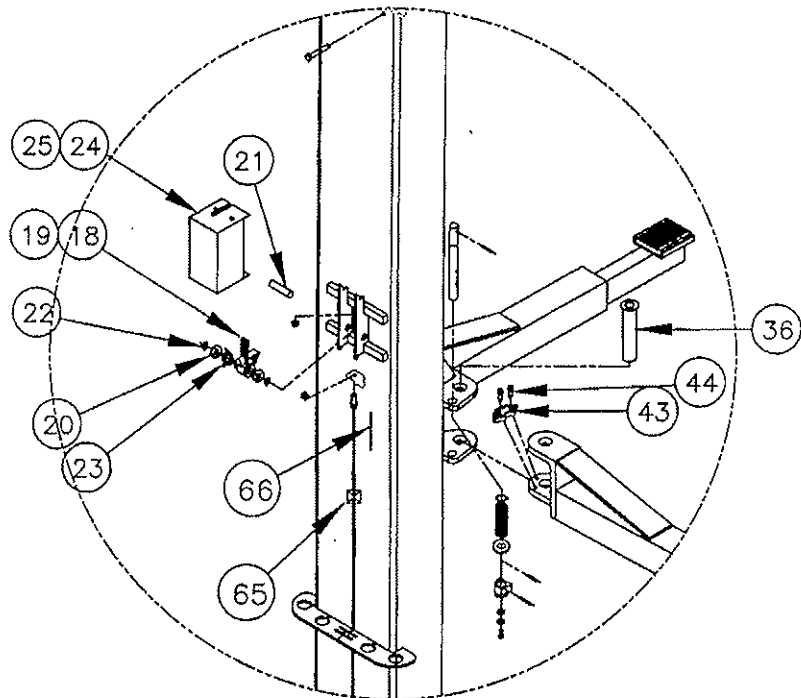
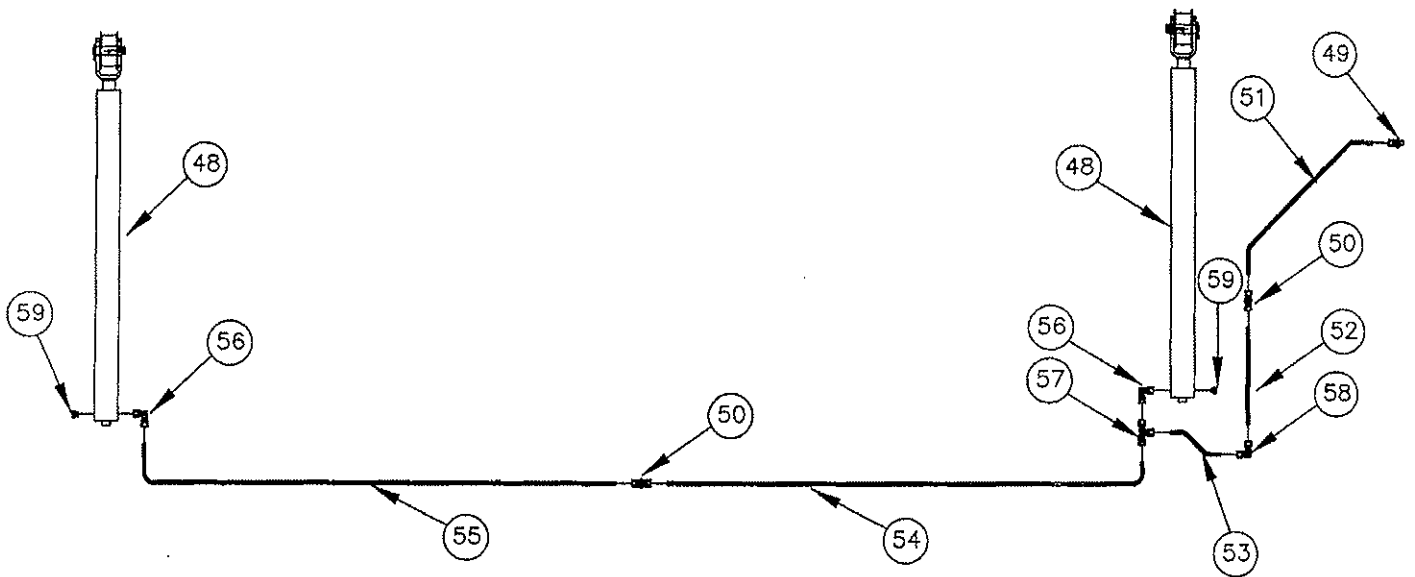
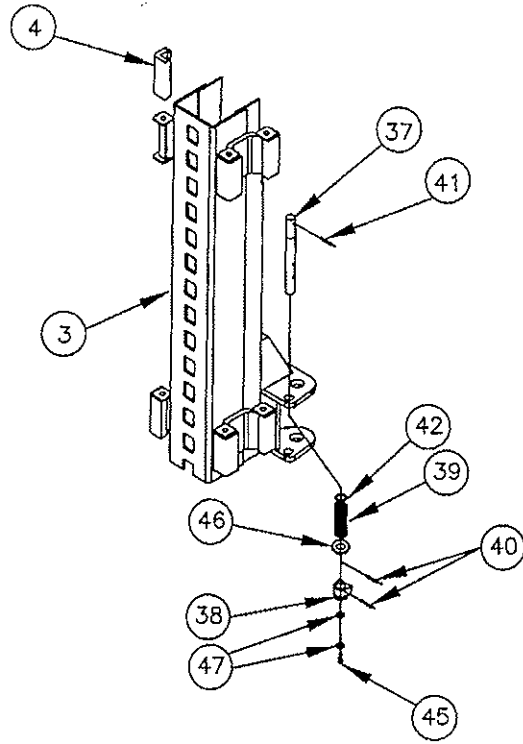

FIG #1

9FC



## PARTS LISTING

12/29/03

	BASE MODEL	9000FC	
	LIFT PART NUMBER	90076	
	OVERALL HEIGHT	141-3/8"	QT
1	POST STRUCTURE - RH	91729	1
2	POST STRUCTURE - LH	91733	1
3	CARRIAGE STRUCTURE	92016	2
4	BEARING BLOCK	91564	16
5	SHEAVE ASSEMBLY	91748	2
6	SHAFT STRUCTURE - OVERHEAD SHEAVE	91755	2
7	SHEAVE	91565	4
8	SNAP RING 3/4"	103000	6
9	FLATWASHER 3/4" SAE	100512	6
10	MOUNT - SHEAVE UPPER	91750	2
11	HHCS 3/8-16NC X 3-1/2" GR 5 ZINC	101032	4
12	BAR TIE	91754	2
13	HFHSL 3/8-16NC X 1"	100238	10
14	HFHSL NUT 3/8-16NC GR 5 ZINC	100239	10
15	CROSSOVER STRUCTURE	91758	1
16	ANCHOR BOLT 3/8" X 3-3/4"	95082	4
17	ACTUATOR CABLE 266"	91731	1
18	CARRIAGE LATCH - RH	91599	1
19	CARRIAGE LATCH - LH	91600	1
#	HANDLE - CARRIAGE STOP	91761	1
20	FLAT WASHER 3/4" SAE	100512	4
#	KNOB	91575	1
21	PIN - PIVOT - CARRIAGE STOP	91576	2
22	3/4" SNAP RINGS	103000	4
23	TORSION SPRING - CARRIAGE STOP	103016	2
24	LATCH COVER POWER UNIT SIDE 9FC	91762	1
25	LATCH COVER OFFSIDE 9FC	91763	1
26	CABLE - EQUALIZER - 9FC 28' 3-3/8"	92037	2
#	HEX NUT 5/8-11NC	100192	8
#	CHAIN - LIFTING 9FC - 89.25"	91764	2
#	PIN SHAFT	91727	4
#	5/16" SNAP RING	103032	8
27	ARM STRUCTURE	91613	4
28	ARM EXTENSION STRUCTURE	91615	4
29	FLATWASHER 3/8 SAE	100082	4
30	3/8 X 3/4 SELF TAPPING SCREW	101025	4
#	LIFT PAD ASSEMBLY	91555	4
31	LIFT PAD STRUCTURE	91556	1
32	PAD LIFT - BOLT ON	91559	1
33	HFHSL 3/8-16NC X 3/4	100179	2
34	LIFT PAD EXTENSION 2-5/8"	91560	4
35	LIFT PAD EXTENSION 5"	91562	4
36	ARM PIN STRUTURE	91063	4

	BASE MODEL	9000FC	
	LIFT PART NUMBER	90076	
	OVERALL HEIGHT	141-3/8"	QT
37	SHAFT - ARM RESTRAINT	91581	4
38	GEAR - LOCKING	91582	4
39	SPRING - ACTUATING - ARM RESTRAINT	103017	4
40	ROLL PIN 3/16 X 1-1/2	103009	8
41	ROLL PIN 1/4 X 2-1/2	103018	4
42	1" SNAP RING	103019	4
43	GEAR - ARM RESTRAINT	91584	4
44	SHCS 3/8-16NC X 1"	101028	8
45	SHCS 5/16-18 X 3/4	101027	4
46	FLATWASHER 1" SAE	100143	4
47	FLATWASHER 5/16" SAE	100088	8
48	CYLINDER ASSEMBLY	91732	2
49	CONNECTOR - STRAIGHT	105023	1
#	PLASTIC CAP	101021	9
50	TUBE UNION	105032	2
51	HYDRAULIC LINE	91766	1
52	HYDRAULIC LINE	91767	1
53	HYDRAULIC LINE	91768	1
54	HYDRAULIC LINE	91769	1
55	HYDRAULIC LINE	91770	1
56	ELBOW - STRAIGHT THREAD	105040	2
57	SWIVEL NUT RUN TEE	105041	1
58	UNION ELBOW	105042	1
59	PLUG 9/16 ORB	105026	2
60	ANCHOR BOLT 3/4 X 5-1/2"	95083	12
61	SHIMS	95001	24
62	POWER UNIT	95103	1
63	HHFL SCR 5/16 X 18NC X 3/4 GR.5	100234	4
64	HHFL NUT 5/16 X 18NC	100237	4
65	ADHESIVE 4 WAY CABLE TIE	103020	4
66	TIE WRAP	103025	4
#	SERIAL NAME PLATE	95056	1
#	BEN PEARSON DECAL	95005	2
#	PB/800 DECAL 2X5 MYLAR	95006	1
#	CAUTION DECAL 9000 LB	95007	2
#	ETL DECAL	95045	1
#	ALI UNIFORM WARNING LABELS	95046	1
#	ALI SAFETY REQUIREMENTS FOR OPERATION	95047	1
#	ALI LIFTING POINT QUICK REF.	95048	1
#	LIFTING IT RIGHT MANUAL	95049	1
#	ALI SAFETY TIPS CARD	95062	1
#	BLUE TOUCH-UP PAINT	103007	1
#	YELLOW TOUCH-UP PAINT	103008	1
#	WARRANTY CARD	83423	1
#	MANUAL	95069	1
#	GREASE 2-EP 1# CAN	95116	1
#	NOT SHOWN		